

G.C.C

DENUMIREA

Bordelesa 150cl

N° DESENULUI

323

MOULD N 00104

DATE TEHNICE:

Capacitatea: 1500 ml
Capacitatea P.R. 1525 ± 10 ml
Greutatea (gr.) 680
Coroana : 0
Culoarea : verde

Grosimea peretilor
nu mai putin (mm): 1.2
Grosimea fundului
nu mai putin (mm): 2.4

LIMITELE DE UTILIZARE

Socul termic.min ($^{\circ}$ C): 40° C
Presiunea nu mai putin
(kgf/cm²): 5
Icarcatura axiala max.(kg.)
Forta verticala max.(kg)

TOLERANTELE (mm)

La verticala: ± 3.3
Pe inaltime: ± 2
La diametru: $+ 1.7$

PRELUCRAREA SUPERFICIALA

Ferbunte : DA
Rece : DA

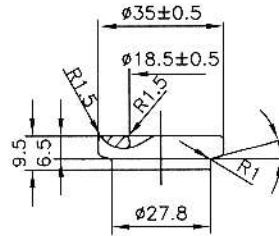
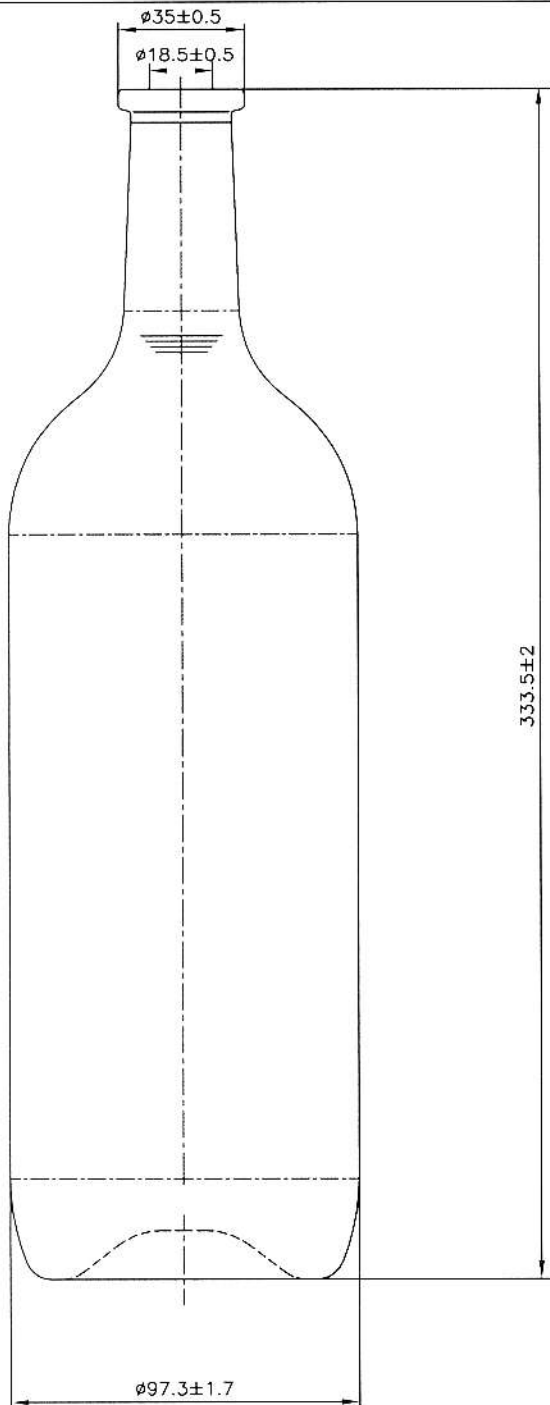

SCHEMA INSTALARII STICLELOR IN PALET

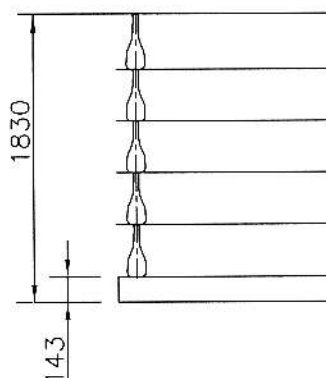
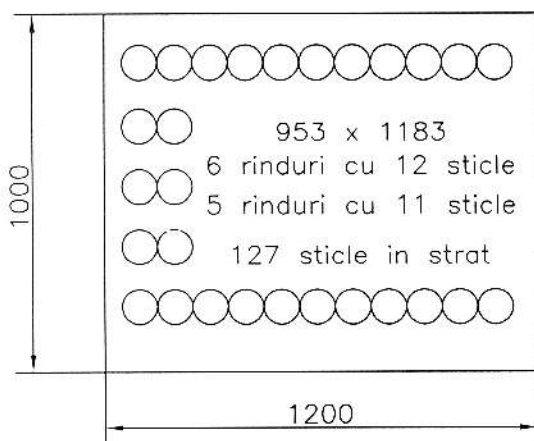

Numarul de straturi in palet: 5
Numarul de sticle in palet : 635
Greutatea paletului (Kg): 480

Palet : 1200x1000
Paleta de jos : 1050x1200
Paleta de mijloc : 1050x1200
Acoperisul: Carton
Invelitoare : Termoprelucrabilo